



# Russell Hobbs

**INSTRUCTIONS AND WARRANTY**



**MODEL NO. 18995-56**

**AURA 750W 2-IN-1 GLASS JUG BLENDER**

Thank you for purchasing the Russell Hobbs Aura 750W 2-in-1 Glass Jug Blender. Each unit has been manufactured to ensure safety, reliability and ease of use. Before use, please read these instructions carefully and keep them for further reference.

## **FEATURES OF THE RUSSELL HOBBS AURA 750W 2-IN-1 GLASS JUG BLENDER**

- 750W at maximum load
- Includes spice and coffee mill for tougher ingredients like coffee beans, nuts and spices
- 1.5L glass jug
- Stainless steel blades with serrated edges for effortless blending
- 2 speed settings and a pulse function
- Removable filler cap for pouring ingredients while blending
- Safety lock on base
- Cord storage
- Non slip feet for added stability
- For domestic use only
- 1 year warranty

## **IMPORTANT SAFEGUARDS**

When using any electrical appliance, basic safety precautions should always be followed including the following:

1. Read all instructions and save the instructions provided with this appliance.
2. Do not put the motor unit in water or any other liquid; do not use it in a bathroom or near any source of water.
3. Do not use outdoors.
4. The blender must be used only by a responsible adult.
5. Switch OFF and unplug the blender from the main power supply outlet before dismantling or cleaning.
6. Turn the switch to standby "0" / "OFF" before fitting/ removing the jug to/ from the motor/ base unit.
7. Turn the switch to standby "0" / "OFF" and wait until the blades come to a complete

stop before removing the lid from the jug, and before removing the jug from the motor/ base unit.

8. This appliance is not intended for use by persons (including children) with reduced physical, sensory or mental capabilities, or lack of experience and knowledge, unless they have been given supervision or instruction concerning use of the appliance by a person responsible for their safety.
9. Children should be supervised to ensure that they do not play with the appliance.
10. Do not use the blender without first locking the lid in place.
11. Do not fill the jug with boiling liquids. Allow liquids to cool to a lukewarm temperature before you put them in the jug. This type of temperature would be comfortable to the touch.
12. Do not put your hand into the jug, even when it has been removed for cleaning – the blades are very sharp.
13. Do not come into contact with moving parts.
14. Do not put any other object (spoon, spatula, etc.) into the jug while the blender is plugged in.
15. Do not leave the blender unattended when plugged in.
16. Misuse of this appliance can result in injury.
17. Position the motor unit on a dry, firm, level surface, close to a power socket and out of reach of children.
18. Route the mains lead so that it cannot be caught accidentally or tripped over.
19. Keep the blender and the mains lead away from hotplates, hobs and burners.
20. Store the blender away from direct sunlight and fluorescent light where possible.
21. Do not let the jug overflow. If liquid gets under the motor unit, it may be sucked into the motor, damaging it.
22. Do not fill the jug above the MAX mark. If you do, the contents may force the lid off when you start the motor.
23. The blender is equipped with a powerful motor and therefore processes very quickly. Due to its efficiency there is no need to run the motor for more than 1 minute at a time.
24. Do not run the motor for more than 1 minute, either continuously, or using the pulse setting, otherwise it may overheat. After 1 minute of use, switch it off for at least 2 minutes allowing it to cool to room temperature and allowing it recover.

25. Do not use the blender for any purpose other than those described in these instructions.
26. Do not run the blender empty, as it may overheat.
27. Do not operate the blender after it malfunctions. If the mains lead or plug is damaged, return the blender to the manufacturer in order to avoid any hazard.
28. Children should be supervised to ensure that they do not play with the appliance.
29. Always turn the power off at the power outlet before you remove the plug. Remove by grasping the plug. Do not pull on the electrical cord.
30. This appliance is designed for processing household quantities; it is not suitable for commercial purposes. Use the appliance only for the purpose it was designed for.
31. Do not use this appliance if it or parts of it show visible damage or if the appliance has been dropped.
32. Do not attempt to make any modifications to this appliance.
33. To avoid any risk and to remain within warranty, repairs to this appliance must be carried out by an authorised service agent only.
34. To reduce the risk of injury, never place the blade assembly on the base without the jar properly attached.
35. If the supply cord is damaged, it must be replaced by the manufacturer, its authorised service agent or similarly qualified persons in order to avoid any hazard.
36. Switch off the appliance and disconnect from the power supply before changing accessories or approaching parts that move when in use.
37. Use only accessories provided by the manufacturer for this appliance.
38. Do not run this appliance with an external timer or remote control system.

## PARTS DIAGRAM

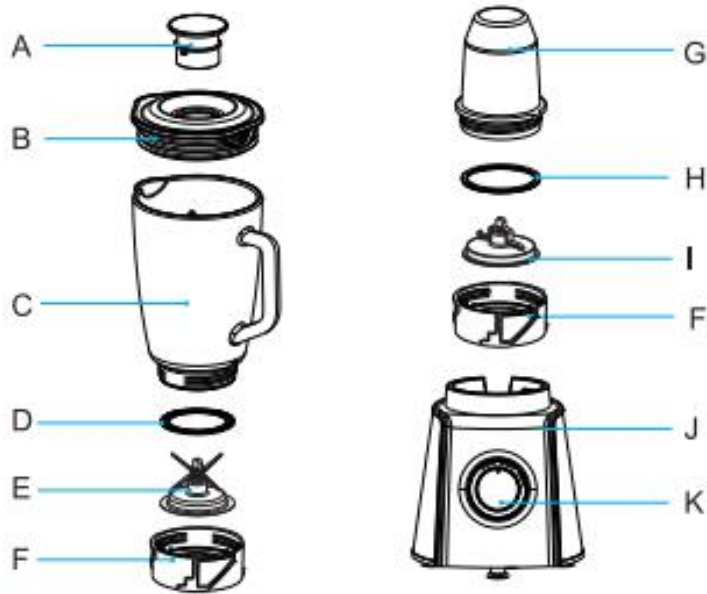

- A. Cap
- B. Lid
- C. 1,5L jug
- D. Jug sealing ring
- E. Blending blade assembly
- F. Jug base

- G. Grinding cup
- H. Grinder sealing ring
- I. Grinder blade assembly
- J. Motor unit
- K. Speed control dial

## BEFORE FIRST USE

Before using your appliance for the first time take it out of the box and take off any protective wrappings. REMEMBER: DO NOT LEAVE PROTECTIVE PACKAGING LYING AROUND, AS IT COULD BE DANGEROUS AROUND INFANTS. Wash the jug, lid and cap in warm soapy water, rinse well and dry. NOTE: The blades are sharp, handle with care.

## OPERATING INSTRUCTIONS

### PREPARATION

- Sit the motor unit on a dry, firm, level surface.

- Align the “arrow” on the bottom of the jug with the “open lock” on the motor unit.
- Lower the jug on to the motor unit, then turn the jug to align the “arrow” with the “closed lock”. Remove the lid.
- Put the ingredients into the jug. Do not fill past the 1.5l mark, or the contents may force the lid off when you start the motor.
- Do not fill with anything hotter than you can comfortably handle (below 40°C). Replace the lid, and press it down to seal it.
- Align the pips on the sides of the cap with the slots in the hole in the lid, put the cap into the hole, and turn it anti-clockwise to lock it.
- Do not run the blender without the cap.

## **POWER UP**

- Check that the speed control is set to 0.
- Put the plug into the power socket and switch on.

## **SPEED CONTROL**

- Turn the speed control clockwise (1 = low, 2 = high). Turn it back to 0 to turn the motor off.
- Use low speed (1) for lighter applications, using mainly liquid ingredients, and high speed (2) for heavier applications, using mainly solid ingredients.
- Turning it fully anti-clockwise will give you a short burst at high speed, for more precise control. In this direction, the control is spring-loaded. When you let go, it will return to 0.
- Do not run the motor for more than 1 minute, it may overheat. After 1 minute switch off for at least 2 minutes, to allow it to recover.

## **ADDING INGREDIENTS**

- To add ingredients while the blender is working, turn the cap anti-clockwise to unlock it, lift it off, add the new ingredients, replace the cap, and turn it anti-clockwise to lock it.
- Check that the added ingredients do not push the volume in the jug over 1.5 litres.

## **POWER DOWN**

- Turn the speed control to 0, and wait until the blades stop moving.

- Turn the jug to align the “arrow” with the “open lock” to unlock it, and lift it off the motor unit.

## **USING THE MILL**

- Turn the mill base and bowl upside down.
- Put the goods to be ground into the bowl – dry goods only.
- Lower the mill base on to the bowl, then twist the base to the right, to lock it in place. Turn the combined mill base and bowl the right way up.
- Align the “arrow” on the bottom of the mill base with the “open lock” on the motor unit. Lower the mill on to the motor unit, then turn, to align the “arrow” with the “closed lock”.
- Turn the speed control in short bursts until you achieve the size of grind you want.
- Turn the mill base to align the “arrow” with the “open lock”, and lift it off the motor unit.
- Turn the mill base and bowl upside down.
- Tap the bowl a couple of times to move all the grounds into the bowl. Hold the bowl, turn the mill base clockwise, and lift it off.

## **Tips for Using Your Blender**

- Do not blend dry, thick or heavy mixtures for more than 60 seconds continuously. Let the appliance cool down before continue operating the appliance again.
- Do not place the lid into boiling water as it may deform.
- To achieve the best results when pureeing solid ingredients, place small portions into the glass jug one by one instead of placing a large quantity all at once.
- If you are processing solid ingredients, cut them into small pieces (2-3cm) first.
- When mixing solid ingredients start off first with a small amount of liquid. Gradually add more and more liquid through the opening in the lid.
- For stirring solid or very thick liquid ingredients we recommend that you use the blender in pulse mode to prevent the blades from becoming stuck.
- Always place your hand on top of the blender when you are operating the device.
- Be careful when processing lukewarm liquids.

## **CLEANING AND MAINTENANCE**

- This appliance is for household use only and is not user-serviceable.
- Do not open or change any parts by yourself. Please refer to a qualified electrical service department or return to the supplier if servicing is necessary.

- Always remember to unplug the unit from the electrical outlet when not in use and before cleaning.
- Do not use bleach or other abrasive substance or solvents to clean your appliance as it can be damaging to the finish.
- Do not immerse the whole unit in water or any other liquid, or hold it under a running tap to clean.
- Unplug the blender from the mains before cleaning and storing away.
- Clean soon after use, to prevent residues settling inside the jug.
- Remove the jug from the motor unit. Wash the jug, lid and measuring cup in warm soapy water, rinse well, then turn the jug upside down to drain and dry.
- Keep hands out of the jug – BLADES ARE VERY SHARP.
- If it is left for too long without cleaning and bits have glued themselves to the inside of the jug, use a nylon brush to remove. If this does not work – crush a few ice cubes in it.
- Wipe the outside of the motor unit with a clean damp cloth.
- Do not put the motor unit in water or any other liquid.

## **STORING THE APPLIANCE**

- Unplug the unit from the wall outlet and clean all the parts as instructed above. Ensure that all parts are dry before storing.
- Store the appliance in its box or in a clean, dry place.
- Never store the appliance while it is still wet or dirty.
- Never wrap the power cord around the appliance.

## **SERVICING THE APPLIANCE**

There are no user serviceable parts in this appliance. If the unit is not operating correctly, please check the following:

- You have followed the instructions correctly
- That the unit has been wired correctly and that the wall socket is switched on.
- That the mains power supply is ON.
- That the plug is firmly in the mains socket.



If the appliance still does not work after checking the above:

- Consult the retailer for possible repair or replacement. If the retailer fails to resolve the problem and you need to return the appliance, make sure that:

- The unit is packed carefully back into its original packaging.
- Proof of purchase is attached.
- A reason is provided for why it is being returned.

If the supply cord is damaged, it must be replaced by the manufacturer or an authorised service agent, in order to avoid any hazard. If service becomes necessary within the warranty period, the appliance should be returned to an approved Home Of Living Brands (Pty) Limited service centre. Servicing outside the warranty period is still available, but will, however, be chargeable.

## CHANGING THE PLUG

Should the need arise to change the fitted plug, follow the instructions below.

**This unit is designed to operate on the stated current only. Connecting to other power sources may damage the appliance. Connect a three-pin plug as follows:**

The wires in this mains lead are coloured in accordance with the following code:

Green/Yellow      = Earth  
Blue                 = Neutral  
Brown                = Live

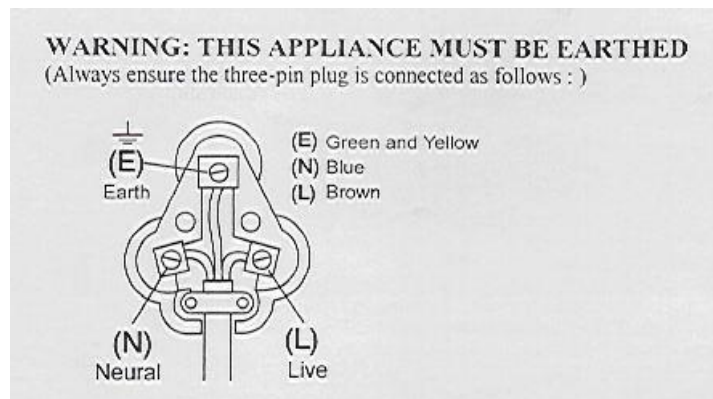

**PLEASE AFFIX YOUR PROOF OF PURCHASE/RECEIPT HERE  
IN THE EVENT OF A CLAIM UNDER WARRANTY THIS RECEIPT MUST BE PRODUCED.**

**WARRANTY**

1. Home of Living Brands (Pty) Limited (“Home of Living Brands”) warrants to the original purchaser of this product (“the customer”) that this product will be free of defects in quality and workmanship which under normal personal, family or household use and purpose may manifest within a period of 1 (one) year from the date of purchase (“warranty period”).
2. Where the customer has purchased a product and it breaks, is defective or does not work properly for the intended purpose, the customer must notify the supplier from whom the customer bought the product (“the supplier”) thereof within the warranty period. Any claim in terms of this warranty must be supported by a proof of purchase. If proof of purchase is not available, then repair, and/or service charges may be payable by the customer to the supplier.
3. The faulty product must be taken to the supplier's service centre to exercise the warranty.
4. The supplier will refund, repair or exchange the product in terms of this warranty subject to legislative requirements. This warranty shall be valid only where the customer has not broken the product himself, or used the product for something that it is not supposed to be used for. The warranty does not include and will not be construed to cover products damaged as a result of disaster, misuse, tamper, abuse or any unauthorised modification or repair of the product.
5. This warranty will extend only to the product provided at the date of the purchase and not to any expendables attached or installed by the customer.
6. If the customer requests that the supplier repairs the product and the product breaks or fails to work properly within 3 (three) months of the repair and not as a result of misuse, tampering or modification by or on behalf of the customer, then the supplier may replace the product or pay a refund to the customer.
7. The customer may be responsible for certain costs where products returned are not in the original packaging, or if the packaging is damaged. This will be deducted from any refund paid to the customer.

**HOME OF LIVING BRANDS (PTY) LTD (JOHANNESBURG)**

JOHANNESBURG

TEL NO. (011) 490-9600

CAPE TOWN

TEL NO. (021) 552-5161

DURBAN

TEL NO. (031) 792-6000

[www.russellhobbs.co.za](http://www.russellhobbs.co.za)  
[www.homeoflivingbrands.com](http://www.homeoflivingbrands.com)  
[www.facebook.com/RussellHobbsSA](https://www.facebook.com/RussellHobbsSA)