



Russell Hobbs®

INSTRUCTIONS AND WARRANTY



MODEL NO. RHCS01

RUSSELL HOBBS CORDLESS HAIR STRAIGHTENER.

Congratulations on purchasing the RUSSELL HOBBS CORDLESS STRAIGHTENER (Model RHCS01). This appliance has been designed to be used on dry hair as well as on towel-dried hair and the CERAMIC PLATES ensure that you can obtain a sleek looking style – without damaging your hair.

Please read the instructions carefully and keep them safe for future reference.

Specification

Product name	RUSSELL HOBBS (cordless hair straightener)
Model No.	RHCS01
Adapter	input AC110V~260V/ output DC5V/2A
Battery	Li-polymer battery 3,600mAh
Heating Temperature	3 Stages(160℃ ,180℃ ,200℃)
Charging time	Minimum 2~3 Hours
Working time	Up to 50 minutes if used in accordance with operating instructions
Weight	188g
Dimensions	L197*W40*H36mm

Parts and functions

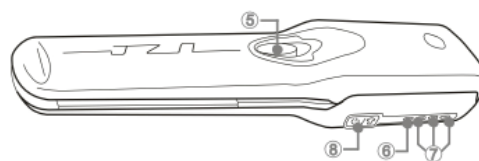
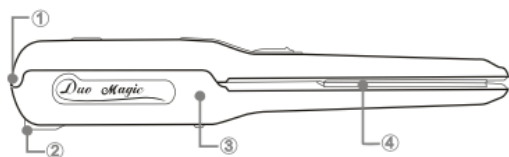

- 1. Upper cover:**
 - Revolves around the axis
- 2. DC-IN:**
 - Power input
- 3. Battery case:**
 - Load li-polymer battery (3600mAh)
- 4. Heating plate:**
 - Heat resource for straightening the hair
- 5. Slide switch:**
 - Device for locking the upper cover
- 6. Battery capacity LED:**
 - Indicates the remaining battery capacity
- 7. Temperature LED:**

- Indicates the heating plate temperature(160 /180 /200)

8. Power ON/OFF Button:

- Power ON/OFF

- Temperature selecting button - Power LED

Instructions for use.

1. Unlock the upper cover.
2. Keep pressing the power button for 2 seconds to turn the straightener on. The power LED turns on with a sound "di---". The temperature LED flashes, at 160 .
3. Choose temperature setting by pressing the power button. Each time you press the button (shorter than 2 seconds with a sound "di") the temperature changes from 160 /180 /200 .
4. When the temperature is reached, there is a sound "di", the temperature LED stops flashing and stays on. I level : 160 / II level : 180 / III level :200

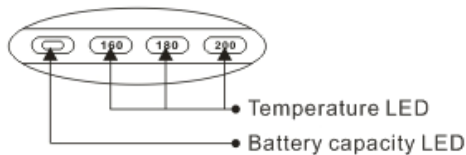

5. Method of using this product as shown in [picture 1].

IMPORTANT SAFEGUARDS

- Always ensure that the power used corresponds to the one indicated on the rating label.
- **NEVER immerse the unit, plug or power cord in water or in other liquids. NEVER use the device near bath tubs, showers, in very damp places or containers full of water.**
- Always unplug the device after use – unless it is charging.
- If it is necessary to rest the straightener while it is heating up or in use, always place the unit on a flat, heat-resistant surface.
- Do not use the device if it is defective, if it has been dropped or if the power cord is damaged. If the device breaks down and / or functions incorrectly, unplug it and do not tamper with it. For any repairs, contact an authorized technical service centre.
- If the power cord is broken, cut or damaged, immediately contact a technical service centre to have it changed.
- Do not attempt to open or dismantle any part of the appliance. Responsibility for failure cannot be accepted if this instruction has been ignored.
- Once styling is completed, unplug the appliance and leave to cool completely before packing away for storage.
- Never unplug the appliance by pulling on power cord or the appliance itself.
- Do not touch the appliance when hands or feet are wet.
- This unit is intended for household use only. Industrial or Commercial use invalidates the warranty.
- Close supervision is required when the appliance is used near or by children and invalids.
- Before carrying out any cleaning or maintenance operation, unplug the appliance from the socket and leave the straightening plates to cool.
- Avoid allowing the hot plates of the straightener to come into contact with the face, neck or scalp.

INSTRUCTIONS FOR USE

- After plugging in the appliance, switch on.. The power indicator will light up reminding you that the straightener is on. It will take about 1 minute for the appliance to heat up to the ideal temperature for carrying out styling.
- To make styling easier, section the hair with clips or hair-bands. Please note that these are not included with the product.
- For best results, apply any styling products prior to straightening.
- Always start at the back of the neck, working up the sides and towards the crown. Finish with the hair at the front.
- Always straighten the lower layers first.
- Take a small section of hair, pull it taut and close the straightener firmly around the hair closest to the scalp i.e. at the roots.
- Run the straightener through the entire length of hair, slowly and steadily, from the roots to the ends without stopping.
- Repeat until the desired amount of straightening or the desired style has been achieved.
- If using on damp hair, you may hear a hissing sound as the excess water evaporates through the vents and the moisture is sealed in.
- Some stylists recommend using a comb or brush on the front pieces of hair to ensure that the hair in the straightener is straight and even.
- You may find that the roots need to be briefly blow dried if you have been unable to get very close to the scalp. This is normal and can be addressed after styling.
- Keep pressing the power button for 2 seconds, and the power would shut off with a sound “di---”.
- When the battery LED flashes and sounds every 10 seconds, it indicates the battery is insufficient.
- Under normal conditions, the Russell Hobbs Straightener can keep on working for around 50 minutes. The working time will vary from using various methods, varied hair or environments etc.

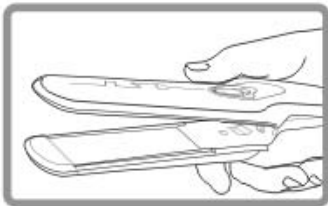

[Picture: 1]

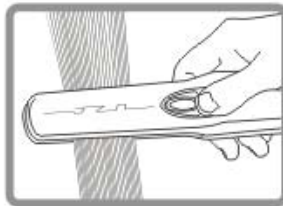

[Picture: 2]

Charging product

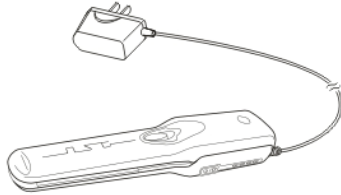

[option 1 .with an adapter]

—Charge by adapter.

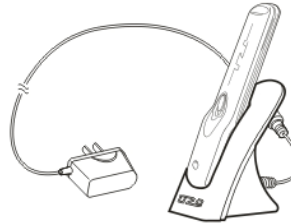

[option 2 .with a charging base(optional)]

—Charge by the charging base.

1. As power indicator light turns on, the charging indicator turns red, and with one sound "di", the charging starts.
2. When power light indicator flashes, the charging indicator turns green, and with consecutive sounds "di", it means the unit is fully charged.

Reference:

- 1). Users can also charge the Straightener from car adapter that matches the charger's DC connector in size.

(note: it is required that the car adapter is with 5V/2A output)

- 2). The more the Straightener is charged, the shorter the working time would be.

When the working time is half shorter than the original working time, please replace the battery.

IMPORTANT INFORMATION

- Ensure that your hair is clean and tangle free.
- If you normally use a heat protection or iron oil spray, this can be applied now before combing or brushing through hair to remove snags and tangles.
- The appliance has been designed so that as well as being able to be used as a dry hair straightener, it can also be used prior to blow drying on towel-dried hair. After washing and conditioning as normal, dry hair with a towel ensuring no dripping water remains in the hair.
- Only hold the appliance by the handle. Avoid touching the hot plates
- Do not scratch the surface of the plates as this will decrease the effectiveness of the ceramic coating.

SAFETY FEATURES

1. When the heating plate reaches up to or over 220 :

The heating plate power cuts off automatically, and will not restart until the temperature is below preset temperature, so as to keep within a safe temperature.

2. When the battery gets too hot, in the process of charging or operating:

If the inner temperature of the battery is over 60 °C, the power will cut off automatically.

3. When the product remains unused for 3 minutes, after switching it on: The infrared sensor will shut the power off.

4. When the product is locked, but the power is switched on:

The safety device would sound “di, di, di, di” and shut off.

5. When error occurs or something wrong with the circuit, sensor or heat board:

The inner safety sensing circuit will shut off the power automatically.

6. When the battery capacity is insufficient:

The battery checking LED will keep flashing for a while and shut off, so as to prevent energy consumption.

Sound functions

1. Power on: a long sound “di”
2. Power off: a long sound “di”
3. Low capacity: short sound “di” every 10 seconds
4. Temperature adjustment: a short sound “di”
5. Temperature rising finished: a short sound “di”
6. Charging starts: a short sound “di”
7. Full-charged: 2 long sound “di”
8. Warning: 4 short sound “di”

CLEANING AND MAINTENANCE

- Ensure that the unit is unplugged and cool before cleaning. Clean the outside of the handle with a damp cloth.
- Wipe the ceramic plates clean of any styling product build-up.
- **Do not use any abrasive cleaning agents on the ceramic plates as this will damage the surface and the effectiveness of the plates. The warranty does not cover misuse.**

SERVICING THE APPLIANCE

There are no user serviceable parts in this appliance. If the straightener is not operating correctly, please check the following:

- You have followed the instructions correctly
- That the unit has been wired correctly and that the wall socket is switched on.
- That the mains power supply is ON.

If the appliance still does not work after checking the above:

- Consult the retailer for possible repair or replacement. If the retailer fails to resolve the problem and you need to return the appliance, make sure that:

- The unit is packed carefully back into its original packaging.

- Proof of purchase is attached.
- A reason is provided for why it is being returned.

If the supply cord is damaged, it must be replaced by the manufacturer or an authorized service agent, in order to avoid any hazard. If service becomes necessary within the warranty period, the appliance should be returned to an approved Amalgamated Appliance (Pty) Ltd service centre. Servicing outside the warranty period is still available, but will, however, be chargeable.

CHANGING THE PLUG

The unit is supplied with a 2 pin VDE plug, and is not earthed.

If you wish to change the plug to a 3 pin, round pin plug, please connect as follows:

The wires in this mains lead are coloured in accordance with the following code:

No earth wire Blue = Neutral Brown = Live

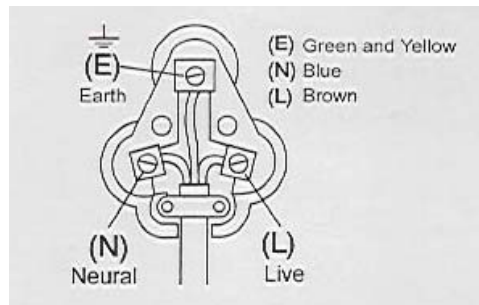

PLEASE NOTE: THIS IS A CLASS II PRODUCT AND DOES NOT NEED TO BE EARTHED

**PLEASE AFFIX YOUR PROOF OF PURCHASE/RECEIPT HERE
IN THE EVENT OF A CLAIM UNDER WARRANTY THIS RECEIPT MUST BE
PRODUCED.**

WARRANTY

Amalgamated Appliances (Pty) Limited (“the Supplier”) warrants to the original purchaser of this product (“the Customer”) that this product will be free of defects in material and workmanship which under normal, personal, family or household purpose manifest themselves within a period of 365 days from the date of purchase or in respect of commercial or professional purposes, manifest themselves within a period of 90 days from the date of purchase. Any claim in terms of the warranty must be supported by a proof of purchase. If such proof is not available, then notwithstanding anything to the contrary herein, the Supplier’s normal charge for service and/or spares will be payable by the Customer upon collection of the repaired product. If a claim is made in terms of the aforesaid warranty within the first 7 days from the date of purchase, the faulty product will be exchanged (provided that the product is in its original packaging with all accessories). Failing return of the product within 7 days, the Supplier’s liability shall be limited on return to the Supplier of the product or parts thereof, to the replacement or repair (in the sole discretion of the Supplier, or its duly authorised service dealer) of the product to eliminate any defect in workmanship or materials found to be due exclusively to any acts or omissions on the parts of the Suppliers, of which defects the Supplier shall have been notified in writing by the Customer within the aforesaid warranty period. The warranty provided herein and the obligations of the Supplier as aforesaid are in lieu of, and the Customer waives, all other warranties, guarantees, conditions or liabilities, express or implied, arising by law or otherwise, including without limitation, any obligation of the Supplier in respect of any injury, loss or damage (direct, indirect or consequential) arising out of the use of, or inability to use, this product and whether or not occasioned by the Supplier’s negligence (gross or otherwise) or any act or omission on its part. The warranty does not include and will not be construed to cover products damaged as a result of disaster, misuse, abuse or any non-authorized modification of the product. The warranty does not include replacement of light bulbs, heater bars, paper bags or any glass, plastic bowl or jug or other expendables. During the warranty period the product should be taken to a service centre of the Supplier or one of its duly authorised service agents. The Supplier neither assumes nor authorises any other person to assume for it, any additional liability in connection with the sale or servicing of its products.

AMALGAMATED APPLIANCES (PTY) LTD

JOHANNESBURG
29 HERONMERE ROAD
P O BOX 39186
BOOYSENS, JOHANNESBURG, 2016

TEL NO. (011) 490-9000

CAPE TOWN
DURBAN

TEL NO. (021) 535-0600
TEL NO. (031) 792-6000

WIN PRIZES ONLINE – www.russellhobbs.co.za