

Russell Hobbs®

INSTRUCTIONS AND WARRANTY



MODEL NO. RHSB045

RUSSELL HOBBS STICK BLENDER

Congratulations on purchasing our **RUSSELL HOBBS STICK BLENDER**. Each unit is manufactured to ensure safety and reliability. Before using this appliance for the first time, please read the instruction manual carefully and keep it for future reference.

IMPORTANT SAFEGUARDS

When using any electrical appliance, basic safety precautions should always be followed including the following:

CAUTION: When using the stick blender, the unit must not be used for longer than 1-minute cycles as this puts pressure on the motor which lead to overheating and product malfunction. It is recommended to allow the stick blender a 15-minute break after each cycle.

1. Please read the instructions carefully before using any appliance.
2. Always ensure that the voltage on the rating label corresponds to the mains voltage in your home.
3. Incorrect operation and improper use can damage the appliance and cause injury to the user.
4. The appliance is intended for household use only. Commercial use invalids the warranty and the supplier cannot be held responsible for injury or damage caused when using the appliance for any other purpose than that intended.
5. Avoid any contact with moving parts.
6. Close supervision is required when any appliance is used near or by children or invalids.
7. Check the power cord and plug regularly for any damage. If the cord or the plug is damaged, it must be replaced by the manufacturer or a qualified person in order to avoid an electrical hazard.
8. Do not use the appliance if it has been dropped or damaged in any way. In case of damage, take the unit in for examination and/or repair by an authorised service agent.
9. To reduce the risk of electric shock, do not immerse or expose the motor assembly, plug or the power cord to water or any other liquid.
10. Never immerse the unit in water or any other liquid for cleaning purposes.

11. Remove the plug from the socket by gripping the plug. Do not pull on the cord to disconnect the appliance from the mains. Always unplug the unit when not in use, before cleaning or when adding or removing parts.
12. The use of accessory attachments that are not recommended or supplied by the manufacturer may result in injuries, fire or electric shock.
13. A short cord is provided to reduce the hazards resulting from becoming entangled in or tripping over a longer cord.
14. Do not let the cord hang over the edge of a table or counter. Ensure that the cord is not in a position where it can be pulled on inadvertently.
15. Do not allow the cord to touch hot surfaces and do not place on or near a hot gas or electric burner or in a heated oven.
16. Do not use the appliance on a gas or electric cooking top or over or near an open flame.
17. Use of an extension cord with this appliance is not recommended. However, if it is necessary to use an extension lead, ensure that the lead is suited to the power consumption of the appliance to avoid overheating of the extension cord, appliance or plug point. Do not place the extension cord in a position where it can be pulled on by children or animals or tripped over.
18. This appliance is not suitable for outdoor use. Do not use this appliance for anything other than its intended use.
19. DO NOT carry the appliance by the power cord.
20. Do not leave this appliance unattended during use. Always unplug the unit when not in use or before cleaning.
21. Always operate the appliance on a smooth, even, stable surface. Do not place the unit on a hot surface.
22. Ensure that the switch is in the "Off" position after each use.
23. The manufacturer does not accept responsibility for any damage or injury caused by improper or incorrect use, or for repairs carried out by unauthorised personnel.
24. In case of technical problems, switch off the machine and do not attempt to repair it yourself. Return the appliance to an authorised service facility for examination, adjustment or repair. Always insist on the use of original spare parts. Failure to comply with the above mentioned pre-cautions and instructions, could affect the safe operation of this machine.

PARTS DIAGRAM

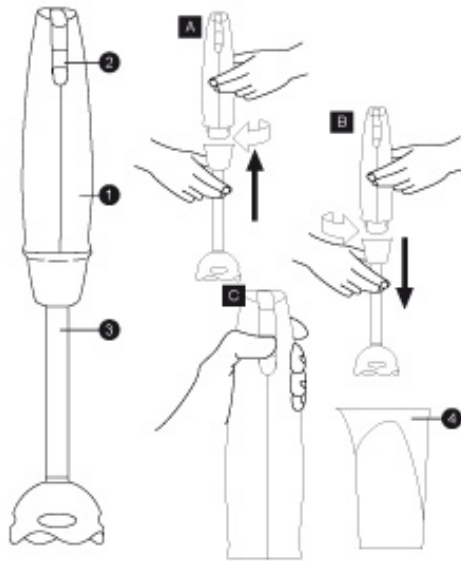

1. Main housing
2. Two-speed switch
3. Removable blending attachment
4. Measuring beaker

OPERATING INSTRUCTIONS

1. Carefully unpack your stick blender and take off any protective wrappings.
2. Clean the blending attachment before using it for the first time with a moist cloth or rinse under the tap. Make sure the unit is unplugged before doing this.
3. Insert the blending attachment into the main housing and turn in a clockwise position until the two parts are locked together **(A)**.
4. Ensure the stick blender is unplugged or switched off at the wall socket.
5. Put the ingredients into a mixing bowl, beaker or a different durable bowl, which is sufficiently tall and wide to avoid splashing.
6. Plug the unit into the mains power supply.
7. Dip the blending arm with blade as deep as possible into the mixture.

NOTE: Do not immerse the stick blender in food or liquid above the “MAX” indicator line.

8. Press the speed button to operate the unit. Partially depressed for normal speed 1 and fully depressed for turbo effect **(C)**, the speed will be changed to speed 2.
9. We recommend first starting on a low speed and increasing the speed as needed, depending on the desired consistency of the food being processed.
10. Work the stick blender through the ingredients with a gentle circular movement and up and down movement.

NOTE: Do not operate the stick blender before inserting it into the food being mixed.

11. When you have finished using your stick blender, unplug the appliance and remove the blending attachment by holding the motor body and turning the blending attachment in an anti-clock wise direction **(B)**.

NEVER USE YOUR APPLIANCE IN A BOWL OR SAUCEPAN WHILE COOKING.

SETTING THE VARIABLE SPEED

You can adjust the speed at which the stick blender operates.

SUGGESTIONS FOR USE

- Move the blending attachment gently around the mixture to ensure uniform results.
- If you want to clean the sides and base of the beaker/container with a hand-held utensil, first switch the machine OFF (by switching it off at the wall socket).
- To avoid unnecessary splashing, immerse the blending attachment into the mixture before switching the appliance ON.
- The speed can be adjusted at any time. Use the LOW speed setting for the thicker consistency. Use the HIGH speed setting for finer consistency.

CLEANING

NOTE: Use extreme care when handling the blade at the bottom of the blending arm. Do not touch the blade with your fingers. The blade is very sharp and can cause injury.

- Make sure the unit is unplugged from the main power supply.
- Disconnect the blending tool from the motor.
- It is much easier to clean the accessories directly after their use.

Wash in warm, soapy water, rinse and dry well.

- The beaker must be washed with luke warm water.
- The body of the stick blender can be cleaned with a damp cloth, and must immediately be buffed with a dry cloth.
- The blending attachment can be washed in warm soapy water or can be washed in a dishwasher.
- To remove stubborn spots wipe the surface with a piece of cloth slightly dampened in soapy water.

Follow with a clean damp cloth.

- When processing foods with colour (e.g. carrots), the parts of the appliance may become discoloured. Wipe these parts with vegetable oil before washing them.
- Do not use any abrasive cleaning material to clean any part of the stick blender, as it will harm the exterior.

CAUTION: The stick blender motor should never be submerged in water or held under running tap water. To clean, simply wipe with a damp cloth and dry thoroughly.

STORING THE APPLIANCE

- Unplug the unit from the wall outlet and clean all the parts as instructed above. Ensure that all parts are dry before storing.
- Store the appliance in its box or in a clean, dry place.
- Never store the appliance while it is still wet or dirty.
- Never wrap the power cord around the appliance.

SERVICING THE APPLIANCE

There are no user serviceable parts in this appliance. If the unit is not operating correctly, please check the following:

- You have followed the instructions correctly
- That the unit has been wired correctly and that the wall socket is switched on.
- That the mains power supply is ON.
- That the plug is firmly in the mains socket.

If the appliance still does not work after checking the above:

- Consult the retailer for possible repair or replacement. If the retailer fails to resolve the problem and you need to return the appliance, make sure that:

- The unit is packed carefully back into its original packaging.
- Proof of purchase is attached.
- A reason is provided for why it is being returned.

If the supply cord is damaged, it must be replaced by the manufacturer or an authorised service agent, in order to avoid any hazard. If service becomes necessary within the warranty period, the appliance should be returned to an approved Amalgamated Appliance (Pty) Ltd service centre. Servicing outside the warranty period is still available, but will, however, be chargeable.

**PLEASE AFFIX YOUR PROOF OF PURCHASE/RECEIPT HERE
IN THE EVENT OF A CLAIM UNDER WARRANTY THIS RECEIPT MUST BE
PRODUCED.**

WARRANTY

Amalgamated Appliances (Pty) Limited ("the Supplier") warrants to the original purchaser of this product ("the Customer") that this product will be free of defects in material and workmanship which under normal, personal, family or household purpose manifest themselves within a period of 365 days from the date of purchase or in respect of commercial or professional purposes, manifest themselves within a period of 90 days from the date of purchase. Any claim in terms of the warranty must be supported by a proof of purchase. If such proof is not available, then notwithstanding anything to the contrary herein, the Supplier's normal charge for service and/or spares will be payable by the Customer upon collection of the repaired product. If a claim is made in terms of the aforesaid warranty within the first 7 days from the date of purchase, the faulty product will be exchanged (provided that the product is in its original packaging with all accessories). Failing return of the product within 7 days, the Supplier's liability shall be limited on return to the Supplier of the product or parts thereof, to the replacement or repair (in the sole discretion of the Supplier, or its duly authorised service dealer) of the product to eliminate any defect in workmanship or materials found to be due exclusively to any acts or omissions on the parts of the Suppliers, of which defects the Supplier shall have been notified in writing by the Customer within the aforesaid warranty period. The warranty provided herein and the obligations of the Supplier as aforesaid are in lieu of, and the Customer waives, all other warranties, guarantees, conditions or liabilities, express or implied, arising by law or otherwise, including without limitation, any obligation of the Supplier in respect of any injury, loss or damage (direct, indirect or consequential) arising out of the use of, or inability to use, this product and whether or not occasioned by the Supplier's negligence (gross or otherwise) or any act or omission on its part. The warranty does not include and will not be construed to cover products damaged as a result of disaster, misuse, abuse or any non-authorized modification of the product. The warranty does not include replacement of light bulbs, heater bars, paper bags or any glass, plastic bowl or jug or other expendables. During the warranty period the product should be taken to a service centre of the Supplier or one of its duly authorised service agents. The Supplier neither assumes nor authorises any other person to assume for it, any additional liability in connection with the sale or servicing of its products.

AMALGAMATED APPLIANCES (PTY) LTD

JOHANNESBURG
29 HERONMERE ROAD
P O BOX 39186
BOOYSENS, JOHANNESBURG, 2016

TEL NO. (011) 490-9000

CAPE TOWN

TEL NO. (021) 535-0600

DURBAN

TEL NO. (031) 792-6000